

M A S K I N G C A P S

ULTRABAKE™ CAPS 600°F (315°C)

Part Number	Color	Fits Thread		Imperial (in) Metric (mm)			Quantity Per Bag
		Metric	UNC	A	B	C	
SC37-0500	CLEAR			0.037	0.100	0.500	1000
				0.94	2.54	12.70	
SC62	DARK BLUE			0.062	0.187	1.000	1000
				1.57	4.75	25.40	
SC70	CLEAR	M2	2-56	0.070	0.170	1.000	1000
				1.78	4.32	25.40	
SC93	PINK		3-48	0.093	0.195	0.750	1000
				2.36	4.95	19.05	
SC93-0500	DARK GREY		3-48	0.093	0.195	0.500	1000
				2.36	4.95	12.70	
SC93-1000	WHITE		3-48	0.093	0.195	1.000	1000
				2.36	4.95	25.40	
SC100-0500	DARK BLUE	M3	4-40	0.100	0.200	0.500	1000
				2.54	5.08	12.70	
SC100	LIGHT GREEN	M3	4-40	0.100	0.200	1.000	1000
				2.54	5.08	25.40	
SC109-0500	YELLOW		5-40	0.109	0.215	0.500	1000
				2.77	5.46	12.70	
SC109	GREY		5-40	0.109	0.215	0.750	1000
				2.77	5.46	19.05	
SC109-1000	WHITE		5-40	0.109	0.215	1.000	1000
				2.77	5.46	25.40	
SC125-0500	LIGHT BLUE		6-32	0.125	0.250	0.500	1000
				3.18	6.35	12.70	
SC125	BLACK		6-32	0.125	0.250	1.000	1000
				3.18	6.35	25.40	
SC140-0500	CLEAR			0.140	0.265	0.500	1000
				3.56	6.73	12.70	
SC140	WHITE			0.140	0.265	1.000	1000
				3.56	6.73	25.40	
SC148-0500	DARK BLUE	M4		0.148	0.240	0.500	1000
				3.76	6.10	12.70	
SC148-0750	DARK GREY	M4		0.148	0.240	0.750	1000
				3.76	6.10	19.05	
SC148	PINK	M4		0.148	0.240	1.000	1000
				3.76	6.10	25.40	
SC156-0500	LIGHT GREEN		8-32	0.156	0.280	0.500	1000
				3.96	7.11	12.70	
SC156	YELLOW		8-32	0.156	0.280	1.000	1000
				3.96	7.11	25.40	
SC156-1250	CLEAR		8-32	0.156	0.280	1.250	1000
				3.96	7.11	31.75	

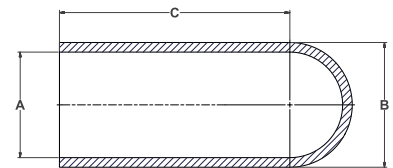

- Recommended for Powder Coating, E-Coating, Plating and Anodizing
- Ultrabake™ Caps mask studs, tube ends, and slotted holes
- Color coding increases visibility and eases the job of sorting plugs after use
- Caps can also be produced in EPDM 350°F (177°C)

MASKING CAPS

ULTRABAKE™ CAPS 600°F (315°C)



- These caps have excellent sealing power and are rugged and durable
- Reusable
- Caps will stretch to mask larger diameters

Part Number	Color	Fits Thread		Imperial (in)			Quantity Per Bag
		Metric	UNC	A	B	C	
SC164-1000	BLACK			0.164	0.292	1.000	1000
				4.17	7.42	25.40	
SC172-0500	GREY		10-24	0.172	0.300	0.500	1000
				4.37	7.62	12.70	
SC172	LIGHT BLUE		10-24	0.172	0.300	1.000	1000
				4.37	7.62	25.40	
SC172-1500	CLEAR		10-24	0.172	0.300	1.500	1000
				4.37	7.62	38.10	
SC180	BLACK	M5		0.180	0.280	1.000	1000
				4.57	7.11	25.40	
SC187-0500	WHITE		12-24	0.187	0.315	0.500	1000
				4.75	8.00	12.70	
SC187-0750	LIGHT BLUE		12-24	0.187	0.315	0.750	1000
				4.75	8.00	19.05	
SC187	CLEAR		12-24	0.187	0.315	1.000	1000
				4.75	8.00	25.40	
SC218	YELLOW			0.218	0.338	1.000	500
				5.54	8.59	25.40	
SC223-0500	DARK BLUE	M6		0.223	0.345	0.500	500
				5.66	8.76	12.70	
SC223-1000	BLACK	M6		0.223	0.345	1.000	500
				5.66	8.76	25.40	
SC223	PINK	M6		0.223	0.345	1.500	500
				5.66	8.76	38.10	
SC234-0500	WHITE		1/4-20	0.234	0.360	0.500	500
				5.94	9.14	38.10	
SC234	LIGHT GREEN		1/4-20	0.234	0.360	1.000	500
				5.94	9.14	25.40	
SC234-1500	YELLOW		1/4-20	0.234	0.360	1.500	500
				5.94	9.14	38.10	
SC250-0500	CLEAR			0.250	0.380	0.500	500
				6.34	9.65	12.70	
SC250	GREY			0.250	0.380	1.000	500
				6.35	9.65	25.40	
SC281-0500	YELLOW		5/16-18	0.281	0.400	0.500	500
				7.14	10.16	12.70	
SC281	LIGHT BLUE		5/16-18	0.281	0.400	1.000	500
				7.14	10.16	25.40	
SC295-0500	BLACK	M8		0.295	0.420	0.500	500
				7.49	10.67	12.70	
SC295-1000	LIGHT GREEN	M8		0.295	0.420	1.000	500
				7.49	10.67	25.40	
SC295	CLEAR	M8		0.295	0.420	1.500	500
				7.49	10.67	38.10	

ULTRABAKE™ CAPS

600 °F (315 °C)

Part Number	Color	Fits Thread		Imperial (in)			Quantity Per Bag
		Metric	UNC	A	B	C	
SC312	WHITE			0.312	0.440	1.000	500
				7.92	11.18	25.40	
SC312-1500	PINK			0.312	0.440	1.500	500
				7.92	11.18	38.10	
SC340	BLACK			0.340	0.460	1.000	500
				8.64	11.68	25.40	
SC355	LIGHT GREEN		3/8-16	0.355	0.485	1.500	500
				9.02	12.32	38.10	
SC375-0500	PINK	M10		0.375	0.505	0.500	500
				9.53	12.83	12.70	
SC375-0750	DARK BLUE	M10		0.375	0.505	0.750	500
				9.53	12.83	19.05	
SC375	YELLOW	M10		0.375	0.505	1.000	500
				9.53	12.83	25.40	
SC375-1500	GREY			0.375	0.505	1.500	500
				9.53	12.83	38.10	
SC406	LIGHT BLUE		7/16-14	0.406	0.531	1.000	500
				10.31	13.49	25.40	
SC437	BLACK			0.437	0.565	1.000	500
				11.10	14.35	25.40	
SC456-1000	PINK	M12		0.456	0.581	1.000	500
				11.58	14.76	25.40	
SC456	CLEAR	M12		0.456	0.581	1.500	500
				11.58	14.76	38.10	
SC468	WHITE			0.468	0.593	1.000	500
				11.89	15.06	25.40	
SC480-1000	LIGHT GREY		1/2-13	0.480	0.605	1.000	500
				12.19	15.37	25.40	
SC480	PINK		1/2-13	0.480	0.605	1.500	500
				12.19	15.37	38.10	
SC500	LIGHT GREEN			0.500	0.625	1.500	500
				12.70	15.88	38.10	
SC535	YELLOW	M14		0.535	0.635	1.500	250
				13.59	16.13	38.10	
SC535-3000	GREY	M14		0.535	0.635	3.000	250
				13.59	16.13	76.20	
SC562	LIGHT BLUE			0.562	0.686	1.500	250
				14.27	17.42	38.10	
SC600	BLACK	M16	5/8-11	0.600	0.724	1.500	250
				15.24	18.39	38.10	
SC625	CLEAR			0.625	0.750	1.500	250
				15.88	19.05	38.10	
SC625-2500	WHITE			0.625	0.750	2.500	250
				15.88	19.05	63.50	

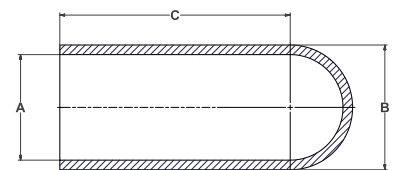

- Recommended for Powder Coating, E-Coating, Plating and Anodizing
- Ultrabake™ Caps mask studs, tube ends, and slotted holes
- Color coding increases visibility and eases the job of sorting plugs after use
- Caps can also be produced in EPDM 350°F (177°C)